



Product information

RNA-hopper

Complete line

Hopper
BU-W



- **Fillvolume from 5 to 200 Litres**
- **Tank and chute in stainless steel, outside brushed**
- **Belt FDA-convenient**
- **Adjustable raised face in stainless steel**
- **Curtain lock**
- **3-phase motor**



Technical details:

Hopper with 3-phase motor						
Type	BU-W 5	BU-W15	BU-W25	BU-W50	BU-W100	BU-W200
max. Fillvolume in Litre	5	15	25	50	100	200
max. Fillweight(kg)	15	50	70	80	100	100
Belt speed	2m/min					
Nominal voltage	230/400 V					
Current consumption (A)	0,37					
	or					
Nominal voltage	230 V					
Current consumption (A)	0,64					
Power (W)	90					
Control: Motorprotection with connection	We advise EBB 1ZDS or EBB 1ZS					
Accessories	Support stands					
Motorposition	The motorposition is right (in running direction) in the standarddesign					

Dimensions

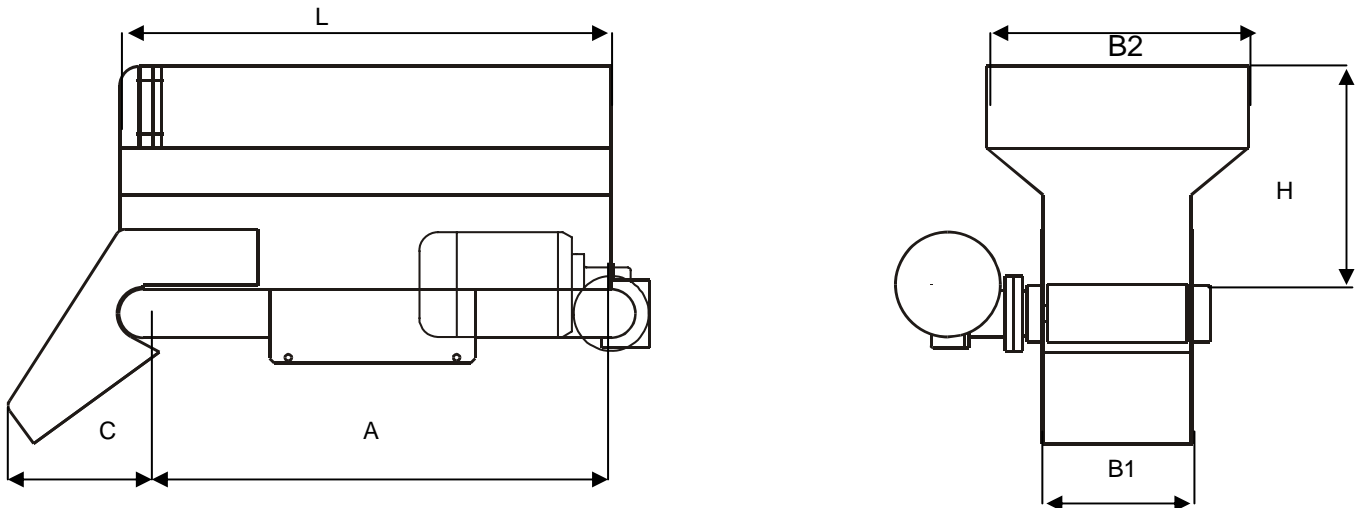

Typ	L	A	B1	B2	H	C
BU-W 5	475	450	120	125	90	145
BU-W 15	475	450	120	250	205	145
BU-W 25	525	500	150	280	235	145
BU-W 50	825	800	250	380	235	145
BU-W 100	1025	1000	300	430	265	145
BU-W 200	1025	1000	300	430	470	145



Fig. shows motorposition left



RNA Automation Ltd

Hayward Industrial Park, Tameside Drive, Castle Bromwich, Birmingham B35 7AG

Tel: +44 (0) 121 749 2566 Fax: +44 (0) 121 749 6217

Email: sales@rna-uk.com Web: www.rna-uk.com